

AT A GLANCE

LIPHATECH®



Liphatech Products At A Glance

Featuring our comprehensive line of rodenticides,
bait stations and SoftSecure™ Technology.

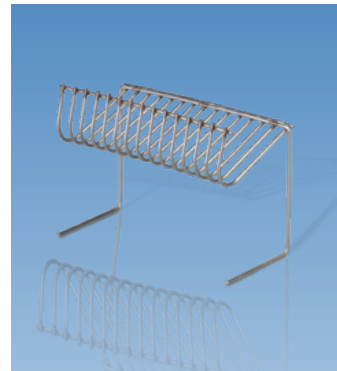

BAITS AT A GLANCE

FirstStrike®

- Active ingredient: difethialone (25 ppm)
- Use for the toughest rodent control challenges
- Maintains integrity in hot environments
- Formula is palatable to rats and mice

Soft Bait (10g pouches)

- 726 pouches per 16 lb. pail
- 363 pouches per 8 lb. pail (case of 2)
- 182 pouches per 4 lb. bag (case of 4)

Soft Bait (40g pouches)

- 182 pouches per 16 lb. pail (includes 5 SSTs)

**FIRST
STRIKE**



Resolv®

- Active ingredient: bromadiolone (50 ppm)
- Good choice for budget-minded accounts
- Maintains integrity in hot environments
- Formula is palatable to rats and mice

Soft Bait (12g pouches)

- 604 pouches per 16 lb. pail
- 151 pouches per 4 lb. bag (case of 4)

Soft Bait (40g pouches)

- 182 pouches per 16 lb. pail (includes 5 SSTs)

RESOLV



TakeDown®

- Active ingredient: bromethalin (100 ppm)
- Faster results than anticoagulant rodenticides
- Maintains integrity in hot environments
- Formula is palatable to rats and mice

Soft Bait (8g pouches)

- 227 pouches per 4 lb. bag (case of 4)

**TAKE
DOWN**



Flatline™

- Active ingredient: chlorophacinone (50 ppm)
- The first and only multiple-feed soft bait rodenticide for everyday use*
- Maintains integrity in hot environments
- Formula is palatable to rats and mice

Soft Bait (28g pouches)

- 65 pouches per 4 lb. bag (case of 8)

FLATLINE



Blocks and soft bait are sold by weight and not by unit. Number of blocks/soft bait pouches per pail/bag are approximates.

*Not registered for sale in all states yet.

BAITS AT A GLANCE

Generation®

- Active ingredient: difethialone (25 ppm)

Mini Blocks (20g blocks)

- 363 blocks per 16 lb. pail
- 90 blocks per 4 lb. bag (case of 4)

Bulk Pellets

- 20 lb. pail

Pellet Place Packs (25g packs)

- 100 packs per pail (4 pails per case)



BlueMax™

- Active ingredient: difethialone (25 ppm)
- Contains mold inhibitors
- Mini blocks contain paraffin for moisture tolerance
- Blue marker dye can be seen in droppings

Mini Blocks (20g blocks)

- 363 blocks per 16 lb. pail
- Ideal for audited accounts

Bulk Meal

- 18 lb. pail
- Effective as a Norway rat burrow bait



Maki®

- Active ingredient: bromadiolone (50 ppm)

Mini Blocks (1 oz. blocks)

- 256 blocks per 16 lb. pail

Paraffin Blocks (1 lb. blocks)

- 20 blocks per box

Bulk Paraffinized Pellets

- 20 pounds per pail
- Approved for burrow baiting

Pellet Place Packs (1.5 oz. packs)

- 75 packs per pail (case of 4)



Rat & Mouse Attractant™

- No active ingredient
- Great for monitoring rodent activity
- Ideal as a snap trap attractant
- Maintains integrity in hot environments
- Based on the same bait formula as FirstStrike

**RAT & MOUSE
ATTRACTANT™**

Soft Bait (10g pouches)

- 363 pouches per 8 lb. pail



NoTox™

- No active ingredient
- Good for monitoring rodent activity
- Red dye visible in droppings
- Based on the bait matrix of Maki mini blocks
- Triangle shape aids in identification

NoTox

Mini Blocks (20g blocks)

- 227 blocks per 10 lb. pail



BAIT STATIONS AT A GLANCE

A E G I S[®]

Valuable features

- See-through pathway designed to encourage entry and feeding by rodents
- Long-lasting mechanical hinge (not available on mouse station)
- Locks open fast and easy, all with same key

Aegis[®]-RP Anchor

- Black or gray with an integrated concrete block
- Use with trap or rodenticide
- Two bolts embedded into concrete
- Pre-assembled station eliminates set-up hassle and costs
- Install either horizontally or vertically
- SST compatible



Aegis[®] Mouse

- All black or with clear lid
- Twice the capacity of most stations
- Specifically designed to hold soft bait



SoftSecure[™] Technology (SST)

- Rodenticide placement device
- Ideal for soft bait and also works with traditional blocks
- Designed for most professional bait stations
- 12 SSTs per case
- Easy to use: peel off paper, place bait, close lid and go



Soft Secure[™]
Technology

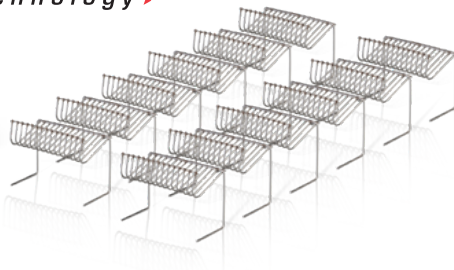

Aegis[®]-RP

- Black or gray
- Use with trap or rodenticide
- Lid opens away from wall
- Compact size
- Install either horizontally or vertically
- SoftSecure[™] Technology (SST) compatible



Aegis[®] Modular

- Black only
- Robust station
- Use with bait, traps or glue boards
- SST compatible



Aegis[®] Rat

- All black, all white (Cool Box) or black with clear lid
- Double-tunnel design for improved bait consumption
- SST compatible



LIPHATECH
— GROUPE DE SANGOSSE